

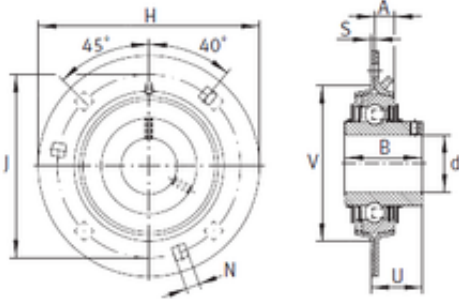

FML ske Manufacturing Co., Ltd

INA GRRY30-VA bearing units



GRRY30-VA Bearing 2D drawings and 3D CAD models

Bearing No. GRRY30-VA

Bore Diameter	30 mm
d	30 mm
V	71 mm
U	24,7 mm
A	9 mm
B	38,1 mm
H	112,7 mm
J	90,5 mm
N	10,5 mm
S	2,5 mm
Category	Flange Block Bearings
Inventory	0.0
Manufacturer Name	SCHAEFFLER GROUP
Minimum Buy Quantity	N/A
Weight / Kilogram	0.754
Product Group	M06110
Number of Mounting Holes	3
Mounting Method	Set Screw
Housing Style	3 Bolt Round Flange Block
Rolling Element	Ball Bearing
Housing Material	Stamped Steel
Expansion / Non-expansion	Non-expansion
Mounting Bolts	10.5 Millimeter
Relubricatable	Yes
Insert Part Number	GYE30KRRBVA
Seals	Double Land Riding Rubber Contact



FML ske Manufacturing Co., Ltd

Housing Configuration	1 Piece Solid
Pilot Configuration	No Pilot
Inch - Metric	Metric
Long Description	3 Bolt Round Flange Block; 30MM Bore; 90.5MM Bolt Circle; 78.5MM Bolt Spacing; 1 Piece Solid; Set Screw Mount; Stamped Steel; Ball Bearing; 38.1MM Length Thru Bore; Relubricatable; Double Land Riding
Other Features	Single Row Corrosion Resistant With Grub Screw
Category	Flange Block
UNSPSC	31171501
Harmonized Tariff Code	8483.20.40.40
Noun	Bearing
Keyword String	Flanged
Manufacturer URL	http://www.ina.com
Manufacturer Item Number	GRRY30VA
Weight / LBS	1.389
Length Thru Bore	1.5 Inch 38.1 Millimeter
Bolt Spacing	3.1 Inch 78.5 Millimeter
Nominal Bolt Circle Diameter Round	3.6 Inch 90.5 Millimeter
Cartridge Pilot Depth	0 Inch 0 Millimeter
Bore	1.181 Inch 30 Millimeter
Cartridge Pilot Diameter	0 Inch 0 Millimeter