

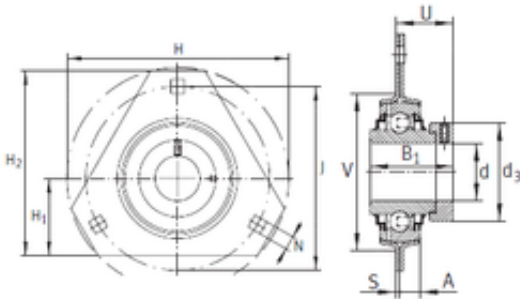

INA RRTR25 bearing units



Bearing No. RRTR25

Bore Diameter	25 mm
d	25 mm
S1	2 mm
V	60 mm
U	28,9 mm
d3	37,5 mm
A	8,7 mm
B1	44,5 mm
H	95,3 mm
H1	34,9 mm
H2	80,5 mm
J	76 mm
N	8,7 mm

RRTR25 Bearing 2D drawings and 3D CAD models