

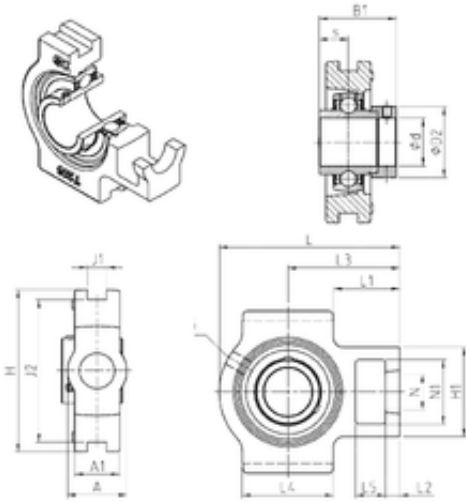

# FML ske Manufacturing Co., Ltd

## SNR EXT318 bearing units

Bearing No. EXT318



EXT318 Bearing 2D drawings and 3D CAD models

Bore Diameter	90 mm
d	90 mm
L4	175 mm
L5	46 mm
L2	32 mm
L3	192 mm
s	43,6 mm
A	110 mm
A1	66 mm
B1	115,9 mm
D2	133 mm
H	255 mm
H1	160 mm
L	312 mm
L1	104,5 mm
N	57 mm
N1	106 mm
Thread (G)	M10x1
J1	32 mm
J2	228 mm
Weight	22,7 Kg
Basic dynamic load rating (C)	143 kN
A2	66 mm
B	87.3 mm
A5	43.7 mm
d1	133 mm



## FML ske Manufacturing Co., Ltd

G	M10x1
H2	160 mm
N2	106 mm
s1	80.15 mm
S	43.6 mm
SW	10 mm
C	143 kN
C0	108 kN
T min.	-20 ° C
T max.	100 ° C
Recommended tightening torque for set screw	120 Nm
Designation of housing	T318-
Designation of bearing	EX318G2