

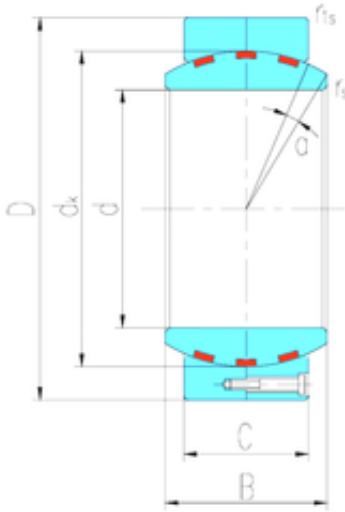

# FML ske Manufacturing Co., Ltd



480 mm x 680 mm x 340 mm LS GEH480HF/Q  
plain bearings

Bearing No. GEH480HF/Q

Size	480x680x340 mm
Bore Diameter	480 mm
Outer Diameter	680 mm
Width	340 mm
d	480 mm
D	680 mm
B	340 mm
C	320 mm
dk	623 mm
r min.	2 mm
r1 min.	5 mm
Angle	2 °
Weight	453 Kg
Basic dynamic load rating (C)	19930 kN

GEH480HF/Q Bearing 2D drawings and 3D CAD models