

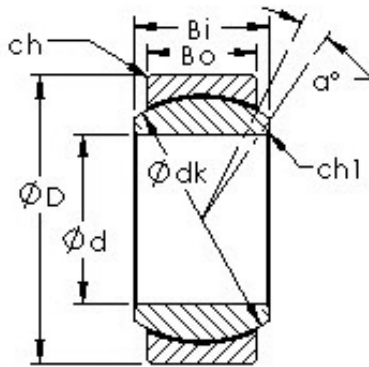

FML ske Manufacturing Co., Ltd



AST GEBJ8C plain bearings

Bearing No. GEBJ8C

Bore Diameter	8 mm
Outer Diameter	19 mm
Bearing Type	wide
Bore Dia (d)	8.0000
Outer Dia (D)	19.0000
Outer Width (Bo)	9.0000
Inner Width (Bi)	12.0000
Dynamic Load Rating (Cr)	13,000
Static Load Rating (Cor)	32,000
Max. shaft corner radius, or 45 deg. chamfer (ch1)	0.300
Max. housing corner radius, or 45 deg. chamfer (ch)	0.300
Spherical Diameter (dk or Dk)	15.880
Mis-alignment Angle (a deg.)	13
Weight (g)	18.00
Material - Outer Ring - Carbon steel, Inner ring	52100 Chrome steel, or equivalent

GEBJ8C Bearing 2D drawings and 3D CAD models