

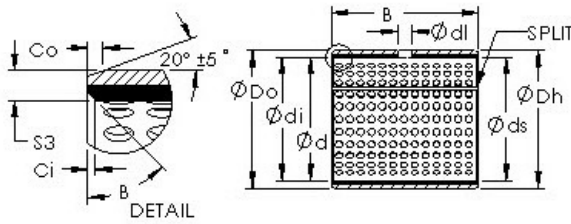

FML ske Manufacturing Co., Ltd



AST AST20 3540 plain bearings

Bearing No. AST20 3540

Bore Diameter	35 mm
Outer Diameter	39 mm
Bearing Type	straight
Shaft Dia., Nominal (d)	35.0000
Shaft Size (ds) - 35 +0 / -0/039	35 +0 / 0/039
Housing Bore Dia. (Dh) - 39 +0.025 / -0	39 +0.025 / 0
Bearing Outside Diameter, Nominal(Do)	39.000
Bearing Outside Diameter Tolerance (Do tol.)	39.085 / 39.045
Bearing Bore after Mounting (di)	35.155 / 35.060
Average Clearance (Cd)	0.1270
Wall Thickness (S3)	1.953
Bearing Length, Nominal (B)	40.000
Bearing Length Tolerance (B tol.) - +0 / -0.40	+0 / 0.40
OD Chamfer Length (Co)	1.200
ID Chamfer Angle (B deg.)	30
ID Chamfer Length (Ci)	0.500
Lube Hole Dia. (dl)	6.000
Material	Carbon steel shell with POM plastic liner

AST20 3540 Bearing 2D drawings and 3D CAD models