

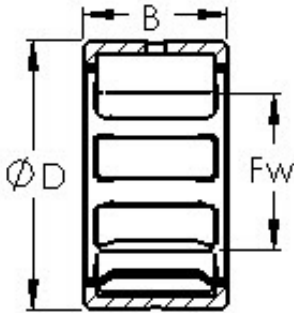

FML ske Manufacturing Co., Ltd



AST NK25/20 needle roller bearings

Bearing No. NK25/20

Size	25x33x20 mm
Bore Diameter	25 mm
Outer Diameter	33 mm
Width	20 mm
Bearing Type	Single Row
Outer Dia (D)	33.0000
Width (B)	20.0000
Dynamic Load Rating (Cr)	18,800
Static Load Rating (Cor)	30,500
Max Speed (Oil) (X1000 RPM)	17,000
Shaft (Fw)	25.000
Weight (g)	42.00
Material	52100 Chrome steel, or equivalent

NK25/20 Bearing 2D drawings and 3D CAD models