

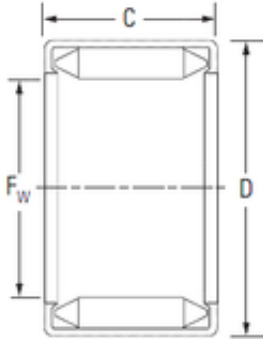

FML ske Manufacturing Co., Ltd

KOYO B1110 needle roller bearings



Bearing No. B1110

| | |
|-------------------------------|------------------------|
| Size | 17.462x22.225x15.88 mm |
| Bore Diameter | 17,462 mm |
| Outer Diameter | 22,225 mm |
| Width | 15,88 mm |
| Fw | 17,462 mm |
| D | 22,225 mm |
| C | 15,88 mm |
| Weight | 0,014 Kg |
| Basic dynamic load rating (C) | 12,8 kN |
| Basic static load rating (C0) | 29 kN |

B1110 Bearing 2D drawings and 3D CAD models